

VENETIAN BLINDS (35mm,50mm)

FITTING GUIDE

What you will need



Child Safety

Young children can be strangled by loops in pull cords, chains, tapes and inner cords that operate the product. To avoid strangulation and entanglement keep cords out of the reach of young children. Cords may become wrapped around a child's neck. Move beds, cots and furniture away from window covering cords. Do not tie cords together. Make sure cords do not twist and create a loop.

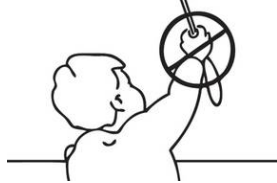

Safety Devices

This product has been supplied with a breakaway safety tassel pre-fitted to the lift cords. If a horizontal force is applied to the cords entering the tassel, it will safely break apart thereby eliminating any hazardous loops. These components have been supplied to make this blind safe in line with the new child safety regulations outlined in BS EN13120.

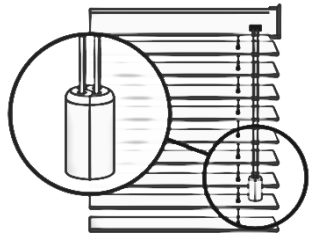

If the safety tassel becomes separated, first untwist and untangle the cords. Place the cords into one half of the tassel and press the tassel together until it is fully closed. You can test it by placing your arm between the cords and pressing downwards. The tassel should break apart with minimal force.

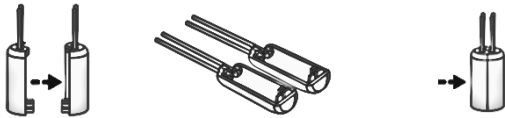

Fitting The Cord Safety Cleat

The safety cleat needs to be installed as close as possible to the headrail and in all cases not less than 1500mm from the floor. The cords must be fully wrapped around the safety cleat(s) when the blind is not in use. Refer to the table to determine the distance required between the cleats to fully accumulate the cords when the blind is completely raised up.

| Drop of Blind | *Distance between cord cleats (centre to centre) |
|---------------|--------------------------------------------------|
| 1-1000mm | 100mm |
| 1001 - 2000mm | 150mm |
| 2001-3000mm | 300mm |

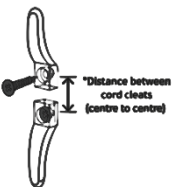

Place the safety cleat in the desired position on the wall and mark the positions of the holes with a pencil. With the hole positions marked, drill as required use the screws provided to attach the safety cleat to the wall.

WARNING

Children can strangle if this safety device is not installed. Always use this device to keep cords or chains out of reach of children. Wrap the cords around the cord cleats in a figure of 8. When the cords are fully accumulated, ensure they are secure so that when any cord is pulled, no excess cord is released.



Venetian Blind System 35mm, 50mm

Preparation

1. Confirm the location of the brackets on the window, options are: Face fix, Top fix, or Side fix as shown below. When positioning the brackets inside the window recess, make sure to allow for any obstructions such as window handles etc.

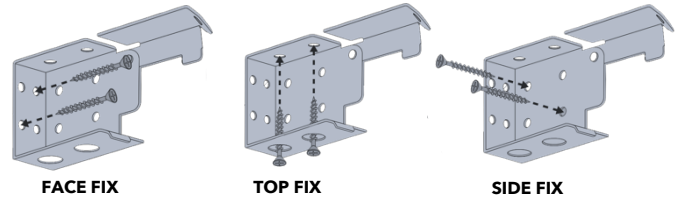

2. Mark with a pencil where the brackets are to be fixed.

3. Depending on the width, some blinds will be supplied with centre support brackets. These need to be aligned with the top of the side (box) brackets. Space them equally along the blind making sure they're clear of any cords. They can be face-fixed, or top-fixed.

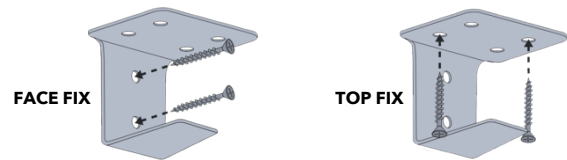

Fitting the Blind

STEP 1

Install brackets firmly into place, use raw plugs where necessary to ensure brackets are secure.

STEP 2

Before installing the blind into the brackets, fit the valance clips to the headrail, spacing them evenly.

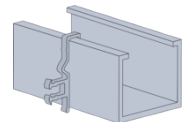

STEP 3

Open the front plate of the box brackets, lift the blind up and slide the headrail into the open brackets ensuring the headrail is sitting in any centre support brackets.



Close the front plate of the bracket and press firmly until it is locked.

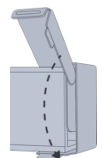

STEP 4

If your blind has been supplied with valance returns, slide the valance return clip into the valance. Slot the other end of the valance clip onto the valance return and push them together until the edges align.

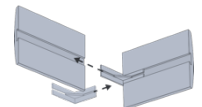

STEP 5 Place the valance onto the valance clips and push it into position.

